

| REVISIONS |                 |        |          |
|-----------|-----------------|--------|----------|
| REV       | DESCRIPTION     | DATE   | APPROVAL |
| —         | DRAWING RELEASE | 2-9-10 | DM       |

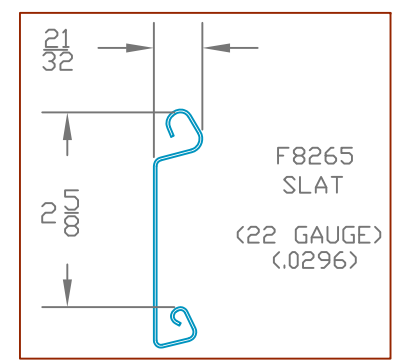
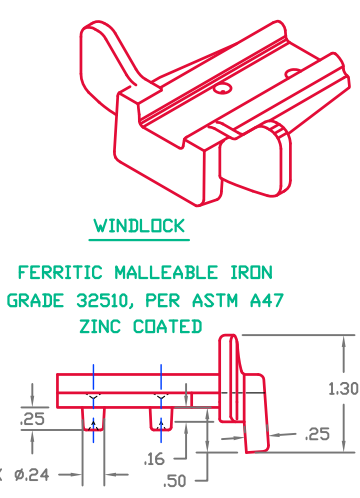
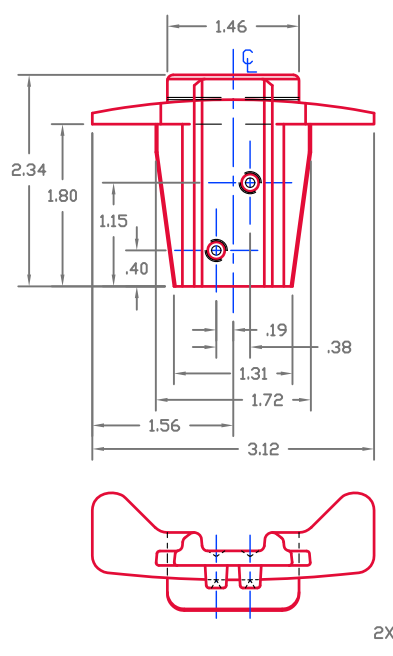
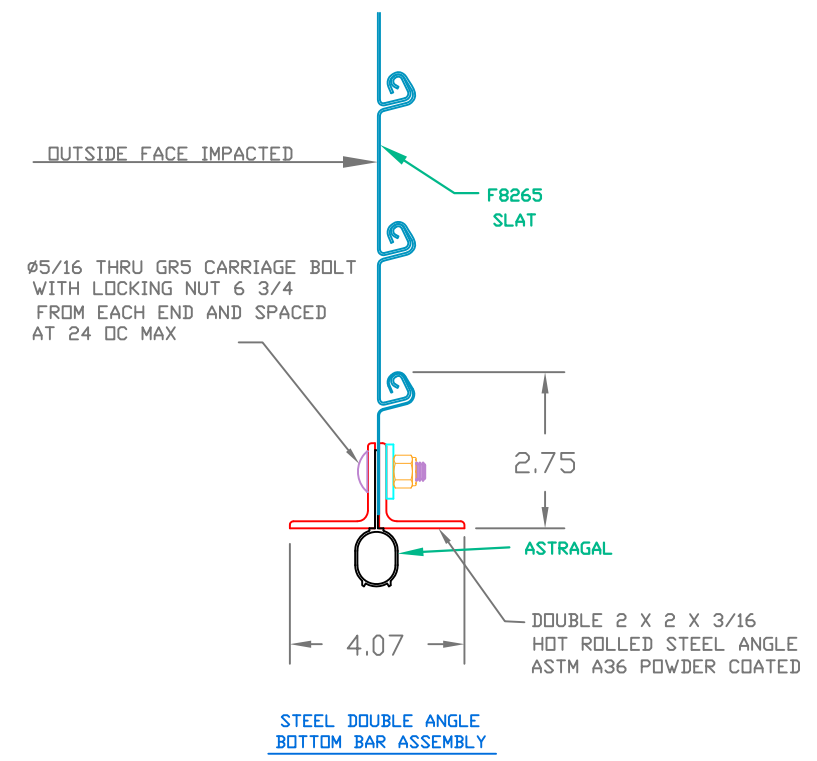
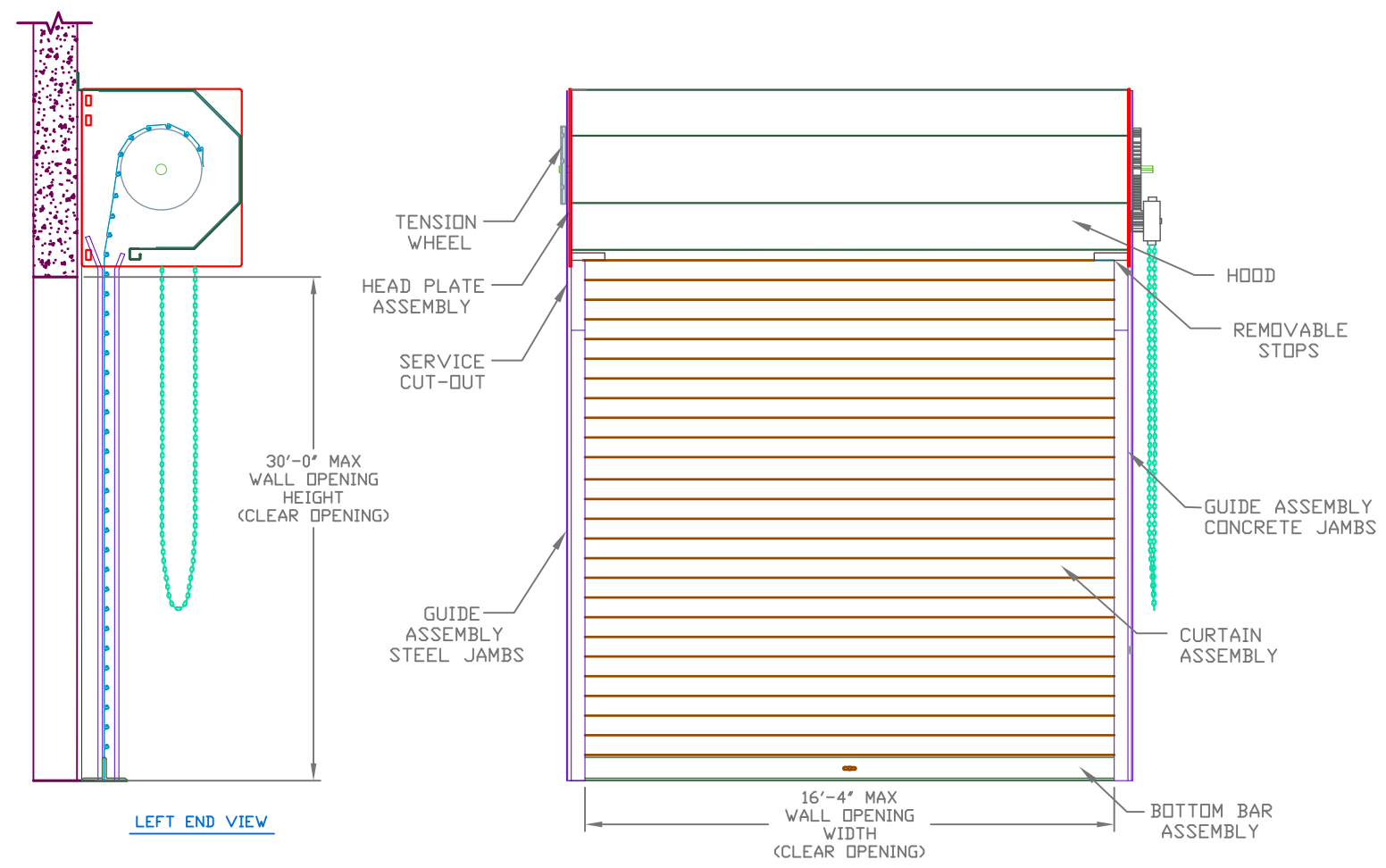

ASTM A653 GR 40 ZINC COATED STEEL  
 PRE-PAINTED WITH FULL COAT OF PRIMER AND BAKED SILICONIZED POLYESTER FINISH COAT

INSIDE ELEVATION  
 RIGHT HAND OPERATION SHOWN - LEFT HAND OPPOSITE

SEE SHEET 2 FOR NOTES

CERTIFIED WIND LOAD AND IMPACT RATED  
 SERIES SD10 ANGLE GUIDES ROLL-UP DOOR ASSEMBLY  
 F8265 SLAT  
 +/- 40.0 PSF MAX. SIZE 16'-4" X 30'-0"



**JANUS INTERNATIONAL CORPORATION®**  
 134 Janus International Blvd. Temple, GA 30179  
 770-562-2850/Fax 770-562-1991  
 © 2010 Janus International Corporation All Rights Reserved

| UNLESS OTHERWISE SPECIFIED, DIMENSIONS ARE IN INCHES AND TOLERANCES ARE |                |       |
|---|----------------|-------|
| ANGLES  | HOLE DIAMETERS |       |
| ± 0' 30'  | UNDER .251     | +0.04 |
| DECIMAL   |                | -0.03 |
| .XX ±.03  | .251 TO .500   | +0.06 |
| .XXX ±.005  |                | -0.03 |
| FRACTIONS   | OVER .500      | +0.08 |
| ± 1/16  |                | -0.03 |

| APPROVALS             | DATE    | APPROVALS             | DATE   |
|-----------------------|---------|-----------------------|--------|
| DRAWN<br>BECKY NELSON | 1-22-10 | APPROVED<br>DON MILLS | 2-9-10 |
| CHECKED<br>DON MILLS  | 2-9-10  |                       |        |

THESE CONFIDENTIAL DOCUMENTS SUBMITTED BY JANUS CONTAIN INFORMATION OF A PROPRIETARY NATURE AND MAY NOT BE REPRODUCED OR USED TO MANUFACTURE ANYTHING IN PART OR IN WHOLE FOR ANY PURPOSE OTHER THAN THAT WHICH IS NECESSARY FOR PREPARATION OF BIDS OR ENGINEERING WITHOUT THE EXPRESS PERMISSION OF JANUS WHICH MAY RECALL DOCUMENTS AT ANY TIME.

|                 |    |                |        |
|-----------------|----|----------------|--------|
| PART NUMBER     | NA | DRAWING NUMBER | RS9007 |
| MATERIAL        | NA | APPLIED FINISH | NA     |
| UNIT OF MEASURE | NA | SCALE          | NONE   |
| SIZE            | B  | SHEET          | 1      |
|                 |    | OF             | 2      |
|                 |    | REV            | —      |

| REVISIONS |                 |        |          |
|-----------|-----------------|--------|----------|
| REV       | DESCRIPTION     | DATE   | APPROVAL |
| —         | DRAWING RELEASE | 2-9-10 | DM       |

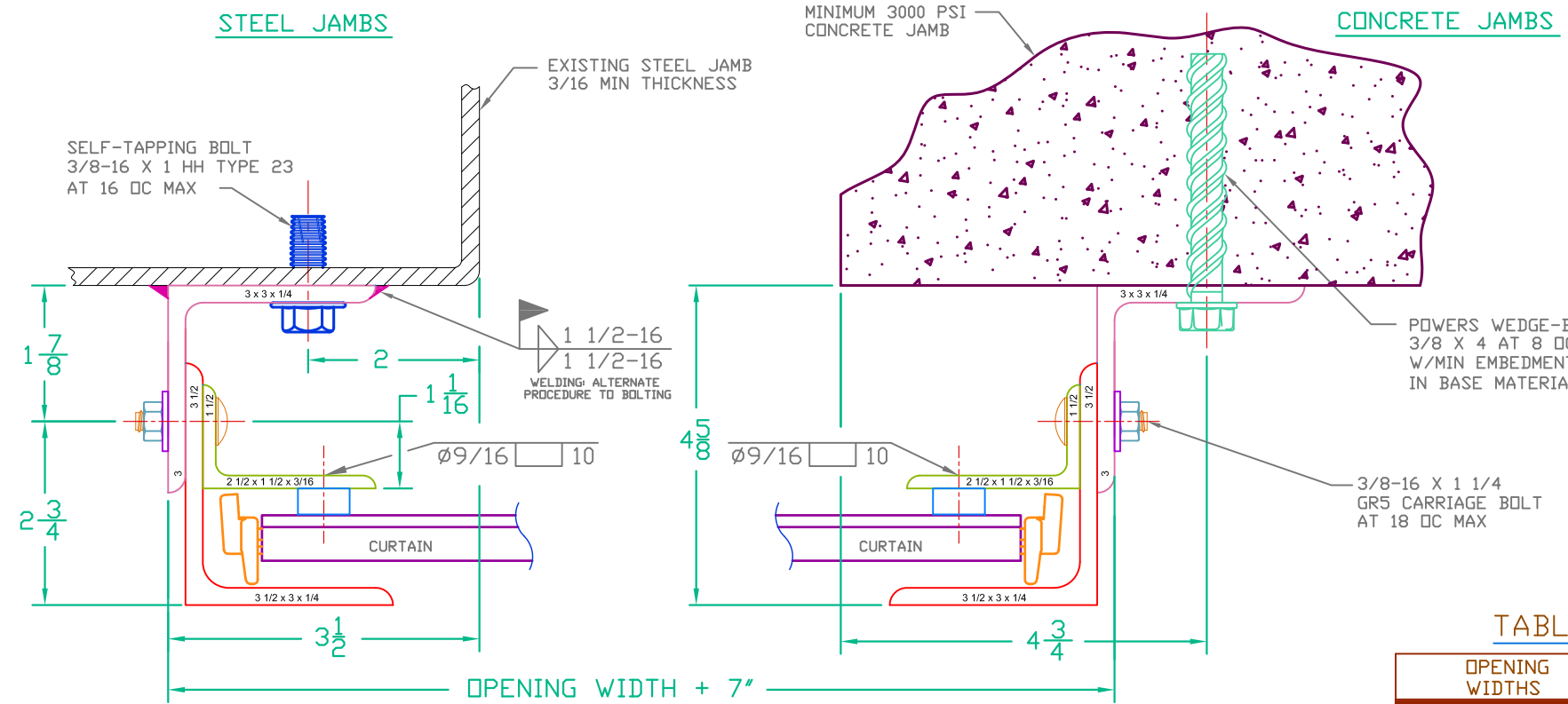

**TABLE 1**

| OPENING WIDTHS   | WINDLOCK SLIP |
|------------------|---------------|
| ≤ 11'-4"         | 3/8           |
| >11'-4" ≤ 16'-4" | 5/8           |

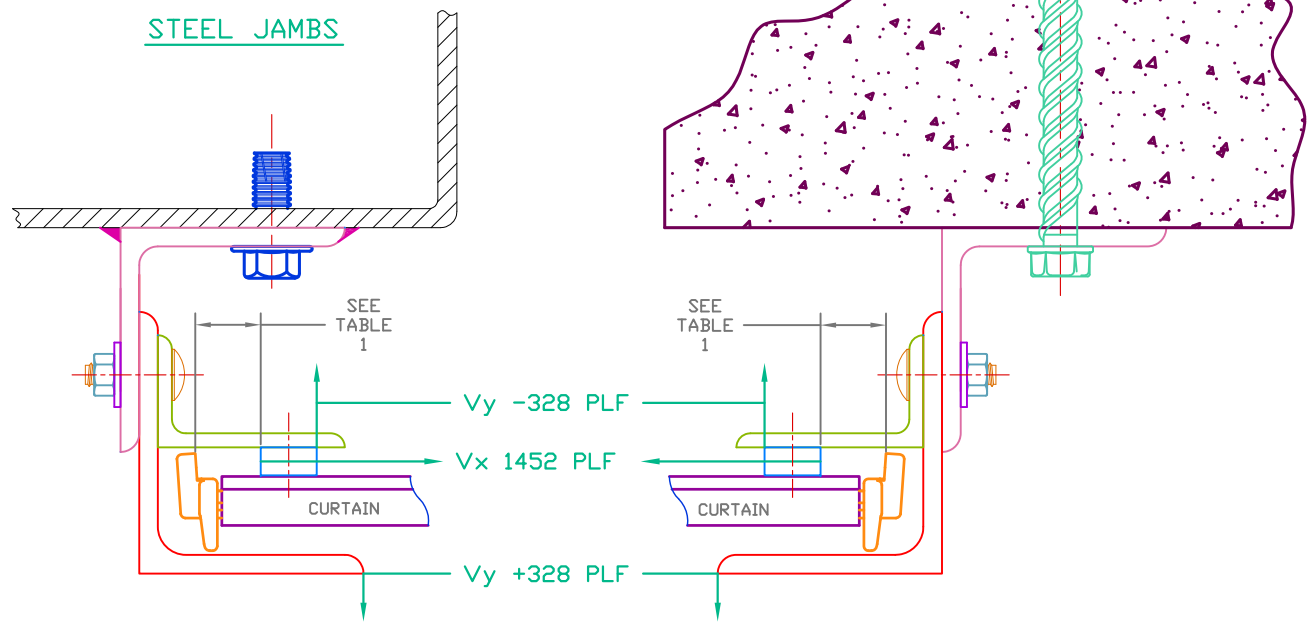

**GENERAL NOTES**

- THIS ROLL-UP DOOR SYSTEM IS DESIGNED IN ACCORDANCE WITH THE FLORIDA BUILDING CODE AND THE INTERNATIONAL BUILDING CODE. THE REQUIRED DESIGN WIND PRESSURES FOR A DOOR IN ANY PARTICULAR BUILDING SHALL BE DETERMINED IN ACCORDANCE WITH SECTION 1609 OF THE FBC. IN CODE JURISDICTIONS OUTSIDE OF FLORIDA, REQUIRED DESIGN WIND PRESSURES MAY BE DETERMINED IN ACCORDANCE WITH SECTION 1609 OF THE IBC OR WITH THE LOCAL BUILDING CODE IN EFFECT FOR THE SPECIFIC LOCATION.
- THIS ROLL-UP DOOR HAS BEEN SUCCESSFULLY TESTED ACCORDING TO THE UNIFORM STATIC AIR PRESSURE TEST PER ASTM E 330 AND ANSI/DASMA 108 TO SAFELY RESIST A POSITIVE AND NEGATIVE WIND LOAD AS NOTED BELOW. A TEST LOAD OF 1.5 X DESIGN LOAD HAS BEEN USED.  
DESIGN LOAD = +40.0 PSF  
-40.0
- THIS ROLL-UP DOOR HAS BEEN SUCCESSFULLY TESTED ACCORDING TO THE LARGE MISSILE IMPACT TEST PER TAS 201 AND ANSI/DASMA 115 WITH THE DIRECTION OF IMPACT BEING TOWARD THE OUTSIDE FACE OF THE CURTAIN SLATS. DOOR IS IMPACT RATED ONLY WHEN INSTALLED ON INSIDE OF AN EXTERIOR WALL. DOOR ALSO SUCCESSFULLY TESTED ACCORDING TO THE CYCLIC WIND PRESSURE LOADING TEST PER TAS 203 AND ANSI/DASMA 115.
- WIND LOADS FOR BUILDING OPENINGS SHALL BE DETERMINED BY A PROFESSIONAL ENGINEER USING APPROPRIATE WIND SPEED AND DESIGN CRITERIA. THIS DOOR MAY BE USED WHERE THE DESIGN LOAD MEETS OR EXCEEDS THE DESIGN LOAD FOR THE BUILDING OPENING.
- SUPERIMPOSED LOADS ON THE JAMBS FROM THIS DOOR ARE DESIGNED AS Vx AND Vy HEREIN. CONTRACTORS SHALL HAVE BUILDING ENGINEER VERIFY ADEQUACY OF BUILDING STRUCTURE TO RESIST SUPERIMPOSED LOADS Vx, Vy
- ALL WELDING SHALL BE PERFORMED BY QUALIFIED WELDERS IN ACCORDANCE WITH AWS SPECIFICATIONS, LATEST EDITION. ALL WELDING ELECTRODES SHALL CONFORM TO AWS A5.1 GRADE E-70.
- ALL BOLTS AND WASHERS SHALL BE GALVANIZED OR STAINLESS STEEL WITH A MINIMUM TENSILE STRENGTH OF 60 KSI.
- DESIGN BASED ON CERTIFIED TESTING LABORATORIES, INC., TEST REPORT NO. CTLA 1959W1 DATED MAY 6, 2009 (STATIC PRESSURE) NO. CTLA 2008W AND CTLA 2008W-3 DATED FEBRUARY 9, 2010 (IMPACT AND CYCLING)
- ANCHOR NOTES:  
A. EMBEDMENT LENGTH DOES NOT INCLUDE STUCCO FINISH.  
B. ANCHORS SHALL BE INSTALLED IN ACCORDANCE WITH MANUFACTURER'S SPECIFICATIONS.
- DOOR OPERATION TYPE TO BE PUSH-UP, HAND CHAIN, HAND CRANK OR ELECTRIC.
- GUIDE TO JAMB ATTACHMENT FASTENERS IN OPENING AREA BEGIN 4 MIN/6 MAX FROM FLOOR AND END 4 BELOW TOP OF WALL OPENING.
- TEST DOOR WALL OPENING SIZE: 16'-4" x 10'-0".
- WINDLOCKS ATTACHED TO EVERY OTHER SLAT BEGINNING AT BOTTOM SLAT (ALTERNATING). WINDLOCKS FASTENED TO SLATS UTILIZING TWO SWAGED MALLEABLE CAST STUDS, .24 BASE DIAMETER, PER WINDLOCK.
- ALTERNATE SLAT GAUGES OF 20 (.0356) OR 18 (.0466) MAY BE SUBSTITUTED, BUT WITH NO INCREASE IN DESIGN LOAD RATING.

UNLESS OTHERWISE SPECIFIED, DIMENSIONS ARE IN INCHES AND TOLERANCES ARE:

| ANGLES      | HOLE DIAMETERS |       |
|-------------|----------------|-------|
| ± 0° 30'    | UNDER .251     | +0.04 |
| DECIMAL     |                | -0.03 |
| .XX ± .03   | .251 TO .500   | +0.06 |
| .XXX ± .005 |                | -0.03 |
| FRACTIONS   | OVER .500      | +0.08 |
| ± 1/16      |                | -0.03 |

| APPROVALS   | DATE    | APPROVALS             | DATE       | PART NUMBER           | DRAWING NUMBER       |
|---|---------|-----------------------|------------|-----------------------|----------------------|
| DRAWN<br>BECKY NELSON   | 1-22-10 | APPROVED<br>DON MILLS | 2-9-10     | NA                    | RS9007               |
| CHECKED<br>DON MILLS  | 2-9-10  |                       |            | MATERIAL<br>NA        | APPLIED FINISH<br>NA |
| THESE CONFIDENTIAL DOCUMENTS SUBMITTED BY JANUS CONTAIN INFORMATION OF A PROPRIETARY NATURE AND MAY NOT BE REPRODUCED OR USED TO MANUFACTURE ANYTHING IN PART OR IN WHOLE FOR ANY PURPOSE OTHER THAN THAT WHICH IS NECESSARY FOR PREPARATION OF BIDS OR ENGINEERING WITHOUT THE EXPRESS PERMISSION OF JANUS WHICH MAY RECALL DOCUMENTS AT ANY TIME. |         |                       |            | UNIT OF MEASURE<br>NA | SIZE<br>B            |
|   |         | SCALE<br>NONE         | SHEET<br>2 | OF<br>2               | REV<br>—             |

CERTIFIED WIND LOAD AND IMPACT RATED  
 SERIES SD10 ANGLE GUIDES ROLL-UP DOOR ASSEMBLY  
 F8265 SLAT  
 +/- 40.0 PSF MAX. SIZE 16'-4" X 30'-0"



**JANUS INTERNATIONAL CORPORATION®**  
 134 Janus International Blvd. Temple, GA 30179  
 770-562-2850/Fax 770-562-1991  
 © 2010 Janus International Corporation All Rights Reserved