

BRACKET ATTACHMENT
 CONCRETE/FILLED BLOCK: POWERS WEDGE-BOLT, 3/8 X 1-3/4" LONG
 STEEL: HEX BOLT, GR.5, 3/8-16 X 1-1/4" LONG

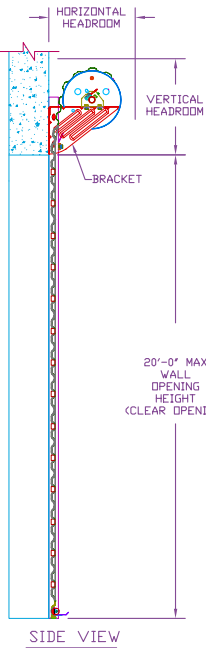

(*)DIMENSIONS SHOWN ARE FOR MOUNTING TO STEEL JAMBS. ADD 1-1/16" WHEN ATTACHING TO CONCRETE OR FILLED BLOCK JAMBS.

(*) FOR PUSH-UP OPERATION: 5-7/8"(*)
 (*) FOR HAND CHAIN OPERATION: 6-5/8"(*)
 (*) FOR ELECTRIC OPERATION: 7-3/8"(*)
 (*) FOR OUTSIDE OF CHAIN DRIVE: 8-1/8"(*)
 NOTE: RIGHT SIDE DRIVE SHOWN

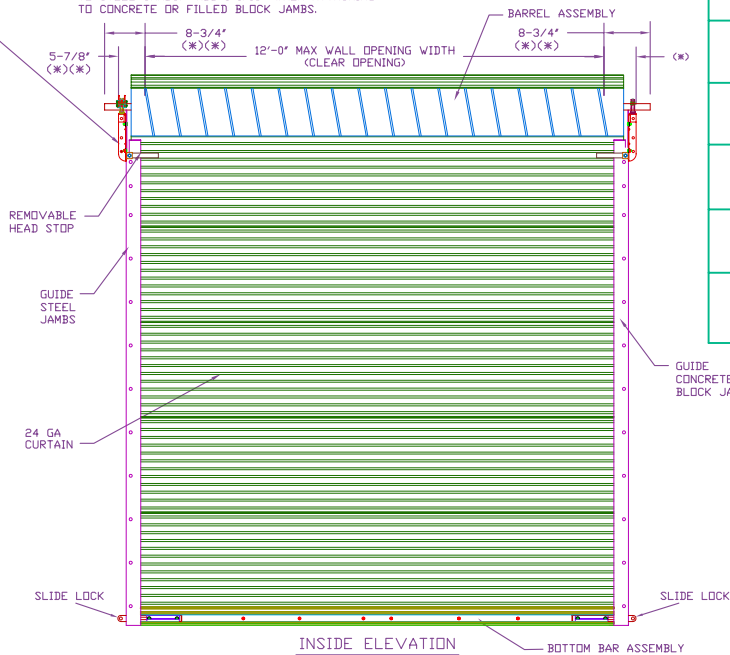

HEADROOM REQUIRED

OPENING HEIGHT	VERTICAL HEADROOM	HORIZONTAL HEADROOM
THRU 8'-0"	17'	19'
OVER 8'-0" THRU 10'-0"	19'	21'
OVER 10'-0" THRU 14'-0"	20'	22'
OVER 14'-0" THRU 16'-0"	21'	23'
OVER 16'-0" THRU 18'-0"	22'	24'
OVER 18'-0" THRU 20'-0"	23'	25'

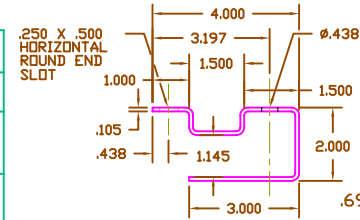

GUIDE
 G90 GALV STEEL
 ASTM A653 W/MIN
 FY=33 KSI
 CONTINUOUS
 FULL JAMB LENGTH

REVISIONS			
REV	DESCRIPTION	DATE	APPROVAL
1	DRAWING RELEASE	3-16-06	DM

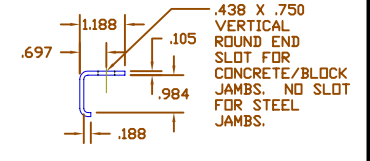

WIND BAR
 WIND BAR G90 GALV STEEL
 ASTM A653 W/MIN
 FY=33 KSI
 CONTINUOUS
 FULL GUIDE LENGTH

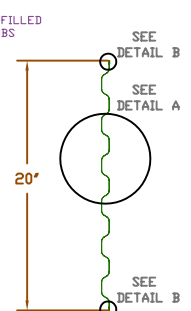
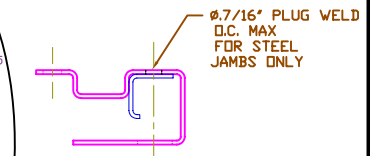

CURTAIN PANEL

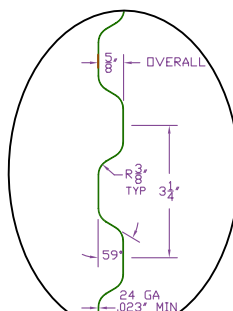

DETAIL A

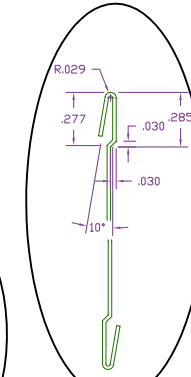

DETAIL B

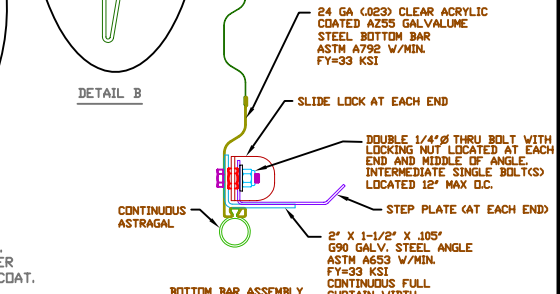

BOTTOM BAR ASSEMBLY

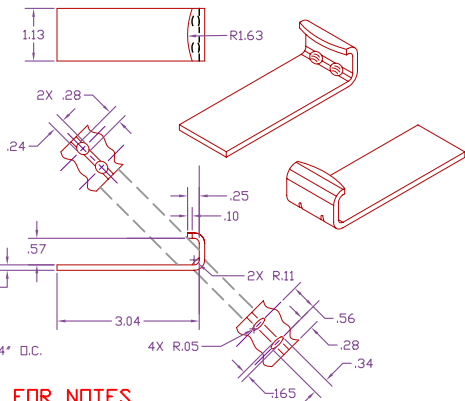

WINDLOCK
 MATERIAL:
 G90 GALV
 ASTM A653
 STRUCTURAL
 STEEL, GRADE 50,
 CLASS 1
 MIN FY=50 KSI

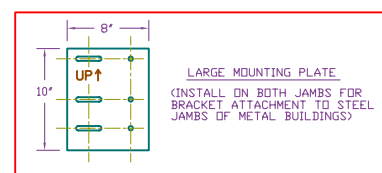

LARGE MOUNTING PLATE
 (INSTALL ON BOTH JAMBS FOR BRACKET ATTACHMENT TO STEEL JAMBS OF METAL BUILDINGS)

ASTM A653 GR 80 MIN FY=80 KSI.
 G90 GALVANIZED STEEL.
 CURTAIN PANELS LOCK SEALED TOGETHER.
 PRE-PAINTED WITH A FULL COAT OF PRIMER
 AND BAKED SILICONIZED POLYESTER FINISH COAT.
CURTAIN DETAIL

STRUCTURAL ENGINEER: JOSEPH H. DIXON, JR. P.E. FL #7768

UNLESS OTHERWISE SPECIFIED DIMENSIONS ARE IN INCHES AND TOLERANCES ARE:

DECIMAL	FRACTIONS	ANGLES	HOLE DIAMETERS
.XX ±.03	± 1/16	± 0° 30'	UNDER .251 +.004 -.003
.XXX ±.005			.251 to .500 +.006 -.003
			OVER .500 +.008 -.003

PART NUMBER: NA	
MATERIAL: NA	
APPLIED FINISH: NA	
UNIT OF MEASURE: NA	
APPROVALS	DATE
DRAWN: BECKY NELSON	1-20-06
CHECKED: DON MILLS	3-16-06
APPROVED: DON MILLS	3-16-06

JANUS INTERNATIONAL CORPORATION
 134 EAST LUKE ROAD TEMPLE, GA 30179-4435
 770-562-2850/Fax 770-562-2264
 © 2006 Janus International Corporation All Rights Reserved

DADE COUNTY COMMERCIAL DOOR SERIES 3400
 MAX. SIZE 12'-0" X 20'-0"

SIZE: B DRAWING NUMBER: T1011

SCALE: NONE SHEET: 1 OF 2

SEE SHEET 2 FOR NOTES

REVISIONS			
REV	DESCRIPTION	DATE	APPROVAL

STEEL JAMBS

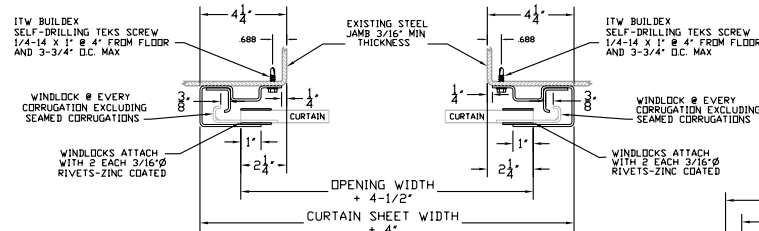

FILLED BLOCK JAMBS

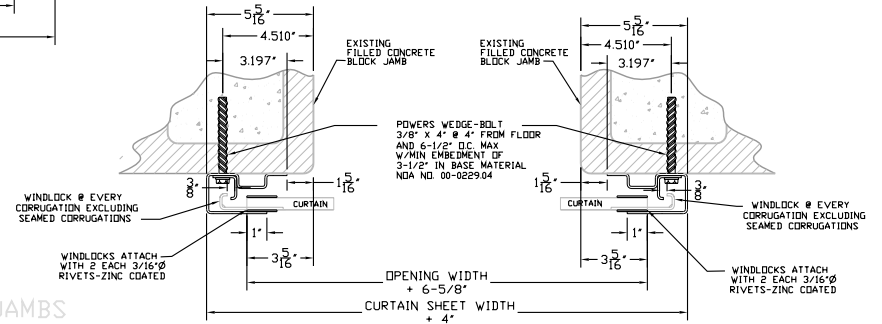

CONCRETE JAMBS

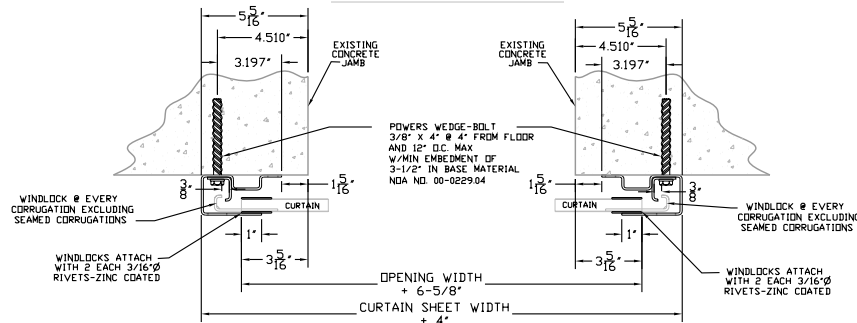

BELOW TOP OF WALL OPENING
13. TEST DOOR WALL OPENING SIZE: 12'-0" x 8'-0"

1 2'

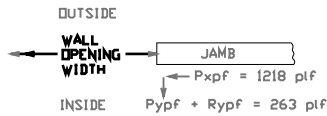

FORCES ON GUIDE TO JAMB ATTACHMENT FASTENERS DUE TO POSITIVE WIND LOAD (FROM OUTSIDE OF BUILDING)

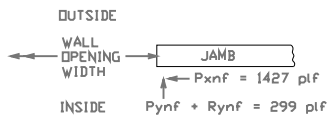

FORCES ON GUIDE TO JAMB ATTACHMENT FASTENERS DUE TO NEGATIVE WIND LOAD (FROM INSIDE OF BUILDING)

STRUCTURAL ENGINEER: JOSEPH H. DIXON, JR. P.E. FL #7768

UNLESS OTHERWISE SPECIFIED DIMENSIONS ARE IN INCHES AND TOLERANCES ARE:

	DECIMAL	FRACTIONS	ANGLES	HOLE DIAMETERS	
.XX	±.03	± 1/16	± 0° 30'	UNDER .251	+ .004 - .003
.XXX	±.005			.251 to .500	+ .006 - .003
				OVER .500	+ .008 - .003